

## Truck Description

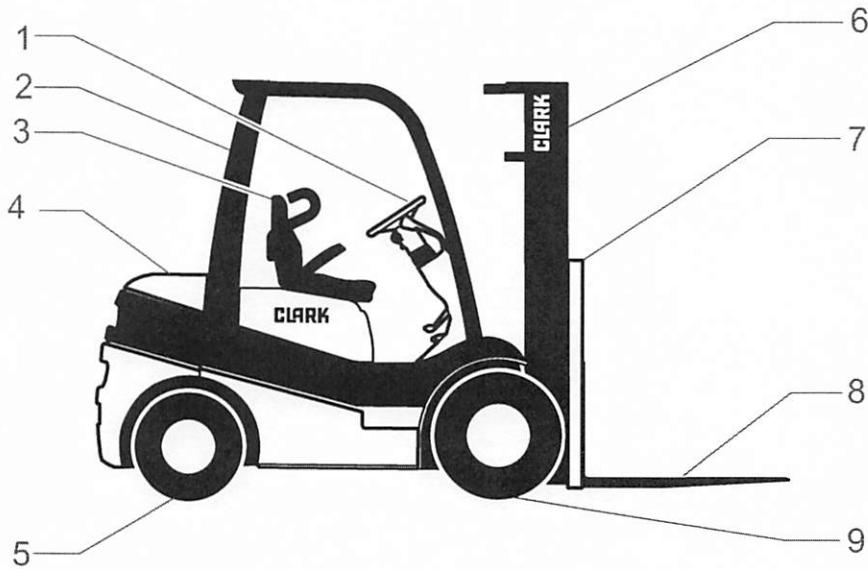

1. Steering Handwheel
2. Overhead Guard
3. Seat and Seat Belt
4. Counterweight
5. Steer Axle, Wheels/Tires
6. Upright and Carriage
7. Load Backrest
8. Forks
9. Drive Axle, Wheels/Tires

The truck shown above is a typical representation of a Clark internal combustion lift truck. Your model may vary slightly.



## Operator Compartment

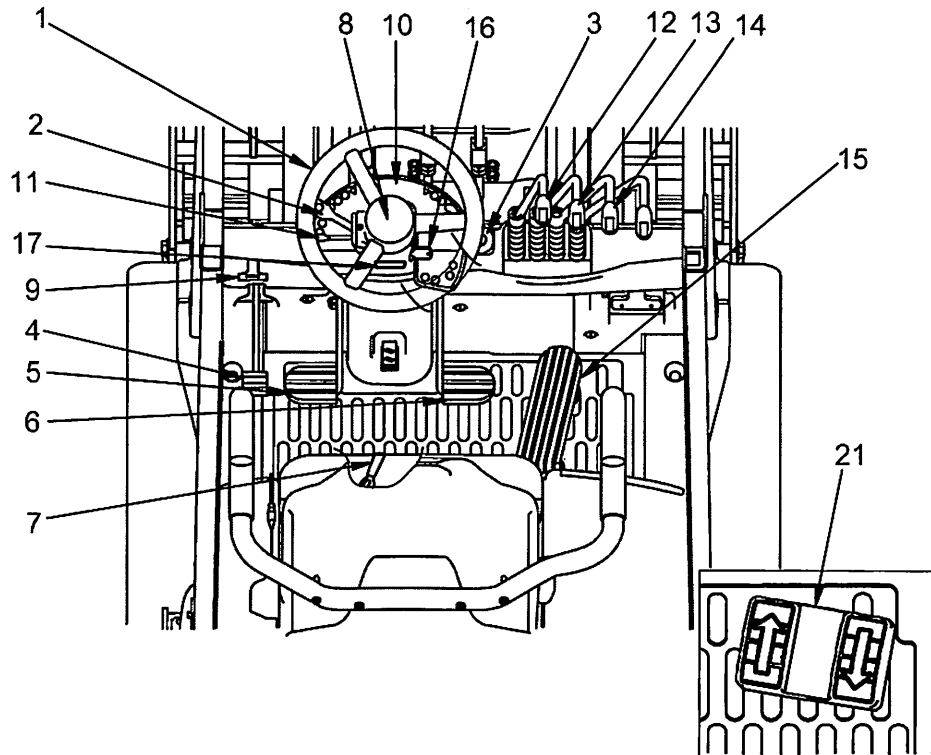

- |                          |                             |
|--------------------------|-----------------------------|
| 1. Steering Handwheel    | 14. Auxiliary Control Lever |
| 2. Forward/Reverse Lever | 15. Accelerator Pedal       |
| 3. Brake Fluid Reservoir | 16. Key Switch              |
| 4. Parking Brake Pedal   | 17. Steer Column Tilt Lever |
| 5. Inching Pedal         | 21. Unitrol pedal(Optional) |
| 6. Service Brake Pedal   |                             |
| 7. Seat Adjustment Lever |                             |
| 8. Horn Button           |                             |
| 9. Parking Brake Release |                             |
| 10. Instrument Pod       |                             |
| 11. Turn Signal Lever    |                             |
| 12. Lift Control Lever   |                             |
| 13. Tilt Control Lever   |                             |

# Do's and Don'ts



**Don't mix drugs or alcohol with your job.**



**Do watch for pedestrians.**



**Don't block safety or emergency equipment.**



**Do wear safety equipment when required.**

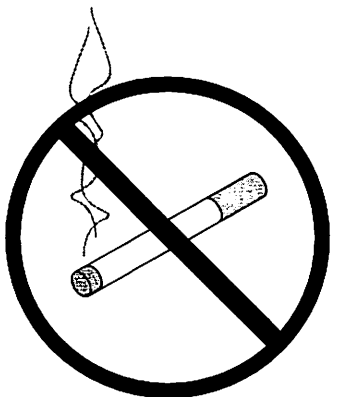

**Don't smoke in "NO SMOKING" areas or when refueling.**

## No Riders



The operator is the only one who should be on a truck.



Never transport personnel on the forks of a lift truck.

## Pedestrians

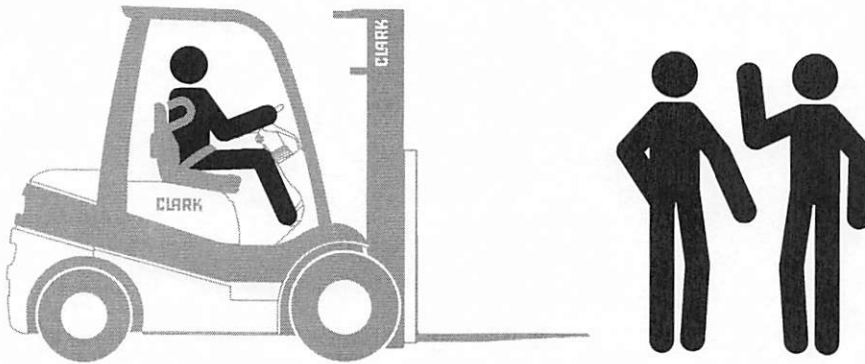

Watch where you are going. Look in the direction of travel. Pedestrians may use the same roadway you do. Sound your horn at all intersections or blind spots. Watch for people in your work area even if your truck has warning lights or alarms. People may not watch for you.



Make people stand back, even when you are parked.

## Operator Protection



**Keep under the overhead guard.  
Always keep your body within the confines of the truck.**

# Fork Safety

Never allow anyone to walk under raised forks.

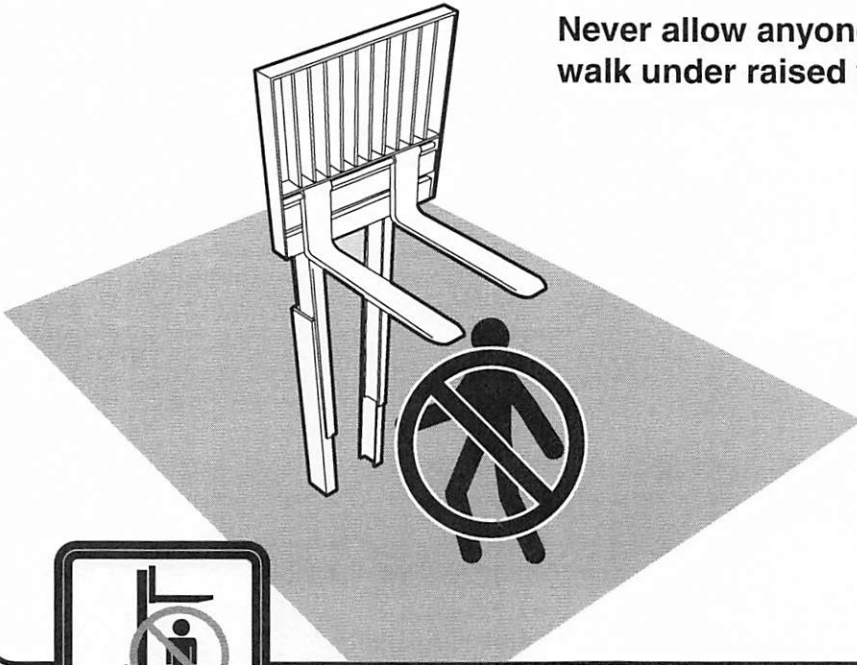

**DANGER**

There is special equipment to raise people for overhead work. **DO NOT USE LIFT TRUCKS.**



## Pinch Points

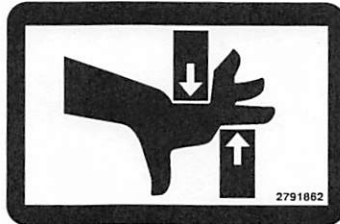

### WARNING

Keep hands, feet and legs out of the upright.

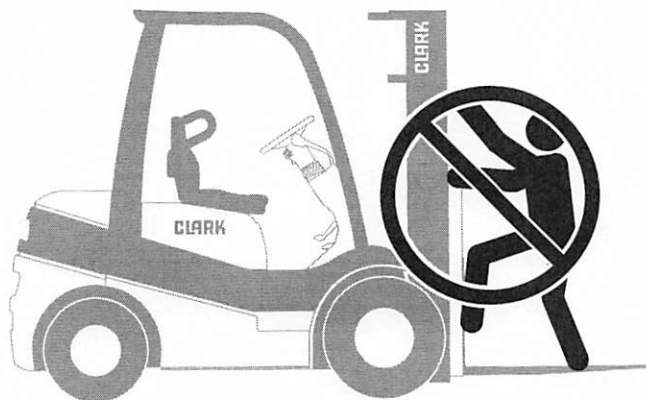

### WARNING

Don't use the upright as a ladder.



### CAUTION

Never try to repair the upright, carriage, chain, or attachment yourself! Always get a trained mechanic.



## Travel

Travel with the load near the floor/ground with upright tilted back to cradle the load whenever possible.

Never lift or lower the load when the truck is in motion.

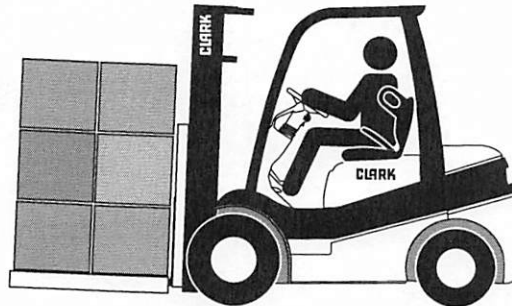

When handling bulky loads that restrict your vision operate your truck in reverse to improve visibility.

Be sure to pivot in the seat to give maximum visibility.

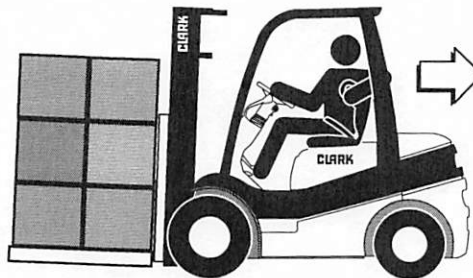

Unstable loads are a hazard to you and to your fellow workers.

Always make certain that the load is well stacked and evenly positioned across both forks.

Never attempt to lift a load with only one fork.

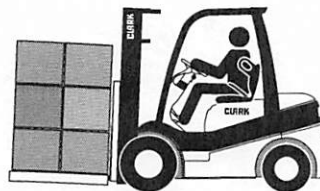

Right



Wrong